

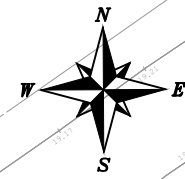

NORTH SOUTH AERIAL VIEW



**NOTES**

THIS IS NOT A CONSTRUCTION DRAWING AND IS FOR INDICATIVE PURPOSES ONLY.  
 THE DRAWING WILL BE SUBJECT TO CHANGE FOLLOWING LOCAL AUTHORITY REVIEW AND CONFIRMATION OF PUBLIC HIGHWAY AND THIRD PARTY LAND BOUNDARIES.

- INDICATIVE SITE BOUNDARY
- DENOTES NEW KERBS

LOCAL AUTHORITY: WREXHAM COUNCIL  
 TOTAL AREA OF SITE: 1.72Ha

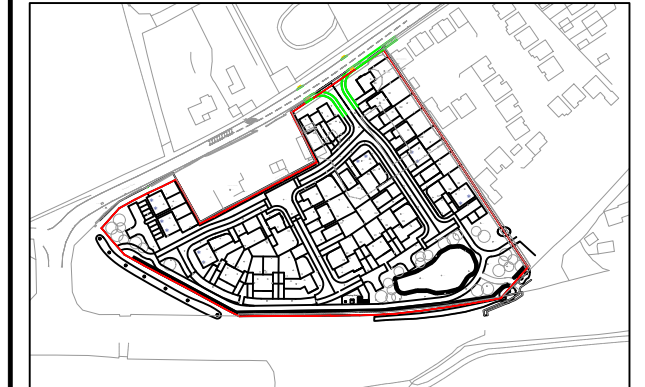

SITE LAYOUT NTS

F	FOOTWAY AMENDMENTS	LB	MR	JAN 22
E	UPDATED LAYOUT	LB	MR	DEC 21
D	UPDATED LAYOUT	LB	MR	DEC 21
C	REVISED TOPO ADDED	LB	MR	JUN 21
B	LAYOUT ADDED	LB	MR	APR 21
A	MINOR AMENDMENT	LB	MR	FEB 21

REV	DETAILS	DRAWN	CHECKED	DATE
-----	---------	-------	---------	------

CLIENT:  
**PRIDDING FARMING PARTNERSHIP**

PROJECT:  
**WREXHAM ROAD, HOLT**

DRAWING TITLE:  
**POTENTIAL SITE ACCESS PLAN**

SCALES:  
**1:500 @ A3**

DRAWN: LB	CHECKED: MC	DATE: FEB 21
-----------	-------------	--------------

Croft Transport Planning & Design  
 340 Deansgate  
 Manchester  
 M3 4LY  
 Email: [info@crofts.co.uk](mailto:info@crofts.co.uk)  
 Tel: 0161 837 7380  
 Web: [www.eddisons.com/services/transport-planning](http://www.eddisons.com/services/transport-planning)

DRAWING NUMBER: <b>3285-F01</b>	REVISION: <b>F</b>
------------------------------------	-----------------------



Z:\projects\3285 Wrexham Road, Holt\CAD\Croft Drawings\3285-F01 Rev F.dwg

